

APPENDIX A – SITE PHOTOGRAPHS

Photo 1. Close-up of foreshore ground, looking southeast. May 30, 2023.



Photo 2. West view of the foreshore environment. May 30, 2023



Photo 3. Invasive species infestation near 431 Quarry Road, looking north. May 30, 2023.



Photo 4. Northeast view of belted kingfisher nesting burrows. May 30, 2023.



Photo 5. North view of upland forested habitat. May 30, 2023.



Photo 6. View of cliff/shoreline bank, looking west. May 30, 2023.



Photo 7. Southwest view of backshore environment at 235 Quarry Road. May 30, 2023.



Photo 8. North view of riprap placement at CRD beach access near 431 Baker Road. May 30, 2023.



PHOTO LOG (SITE DRAINAGE & EROSION)

Created: 10-19-2022
Creator: Bradley Fossen (@BFO)
Status:
Dates: 04-13-2021 - 10-19-2022

Recipients

brad@thinkapg.com

Description

Photo Log
2022.68 BAKER / QUARRY BEACH EROSION

Sheets

2022.68 Quarry - Baker Rd Erosion	2022.68-46-LAY-002	2022.68-46-LAY-004	2022.68-46-LAY-006
2022.68-46-LAY-001	2022.68-46-LAY-003	2022.68-46-LAY-005	

Table of contents

1.1 Observation

#	Description	Plan	Assignee	Status	Page
367	GENERAL PICTURES - 434 BAKER RD AREA	2022.68-46-LAY-006	@BFO	Completed - 10-18-2022	3
368	GENERAL PICTURES - 239 QUARRY DR AREA	2022.68-46-LAY-006	@BFO	Completed - 10-18-2022	4
366	GENERAL PICTURES - 235 QUARRY DR AREA	2022.68-46-LAY-006	@BFO	Completed - 10-18-2022	5
364	BAKER RD BEACH ACCESS & EXISTING RETAINING WALLS	2022.68-46-LAY-006	@BFO	Completed - 10-18-2022	7
363	GENERAL PICTURES - 431 BAKER RD AREA	2022.68-46-LAY-006	@BFO	Completed - 10-18-2022	8
365	QUARRY DR BEACH ACCESS & EXISTING RETAINING WALLS	2022.68-46-LAY-006	@BFO	Completed - 10-18-2022	9

#367 - GENERAL PICTURES - 434 BAKER RD AREA

Completed | Bradley Fossen | 1.1 Observation
Plan: 2022.68-46-LAY-006 - OVERALL LAYOUT
Created 10-18-2022 | Completed 10-18-2022



Task messages (time in MDT)

Bradley Fossen



18 Oct 01:35 PM

Bradley Fossen



18 Oct 01:35 PM

#368 - GENERAL PICTURES - 239 QUARRY DR AREA

Completed | Bradley Fossen | 1.1 Observation
Plan: 2022.68-46-LAY-006 - OVERALL LAYOUT
Created 10-18-2022 | Completed 10-18-2022



Task messages (time in MDT)

Bradley Fossen



18 Oct 01:37 PM

Bradley Fossen



18 Oct 01:37 PM

Bradley Fossen



18 Oct 01:37 PM

#366 - GENERAL PICTURES - 235 QUARRY DR AREA

Completed | Bradley Fossen | 1.1 Observation
Plan: 2022.68-46-LAY-006 - OVERALL LAYOUT
Created 10-18-2022 | Completed 10-18-2022



Task messages (time in MDT)

Bradley Fossen



18 Oct 01:33 PM

Bradley Fossen



18 Oct 01:33 PM

Bradley Fossen



18 Oct 01:33 PM



#364 - BAKER RD BEACH ACCESS & EXISTING RETAINING WALLS

Completed | Bradley Fossen | 1.1 Observation
Plan: 2022.68-46-LAY-006 - OVERALL LAYOUT
Created 10-18-2022 | Completed 10-18-2022



Task messages (time in MDT)

Bradley Fossen

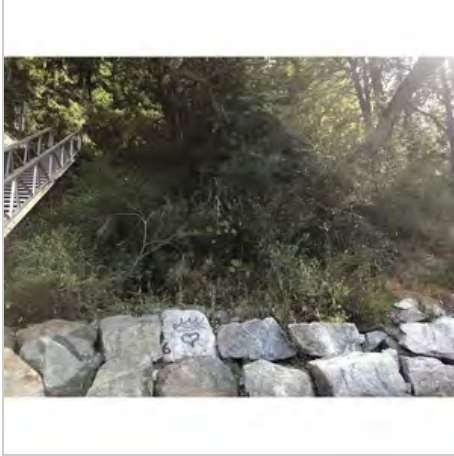

18 Oct 01:29 PM

Bradley Fossen



18 Oct 01:29 PM

#363 - GENERAL PICTURES - 431 BAKER RD AREA

Completed | Bradley Fossen | 1.1 Observation
Plan: 2022.68-46-LAY-006 - OVERALL LAYOUT
Created 10-18-2022 | Completed 10-18-2022



Task messages (time in MDT)

Bradley Fossen



18 Oct 01:27 PM

Bradley Fossen



18 Oct 01:27 PM

Bradley Fossen



18 Oct 01:27 PM

#365 - QUARRY DR BEACH ACCESS & EXISTING RETAINING WALLS

Completed | Bradley Fossen | 1.1 Observation
Plan: 2022.68-46-LAY-006 - OVERALL LAYOUT
Created 10-18-2022 | Completed 10-18-2022



Task messages (time in MDT)

Bradley Fossen



18 Oct 01:31 PM

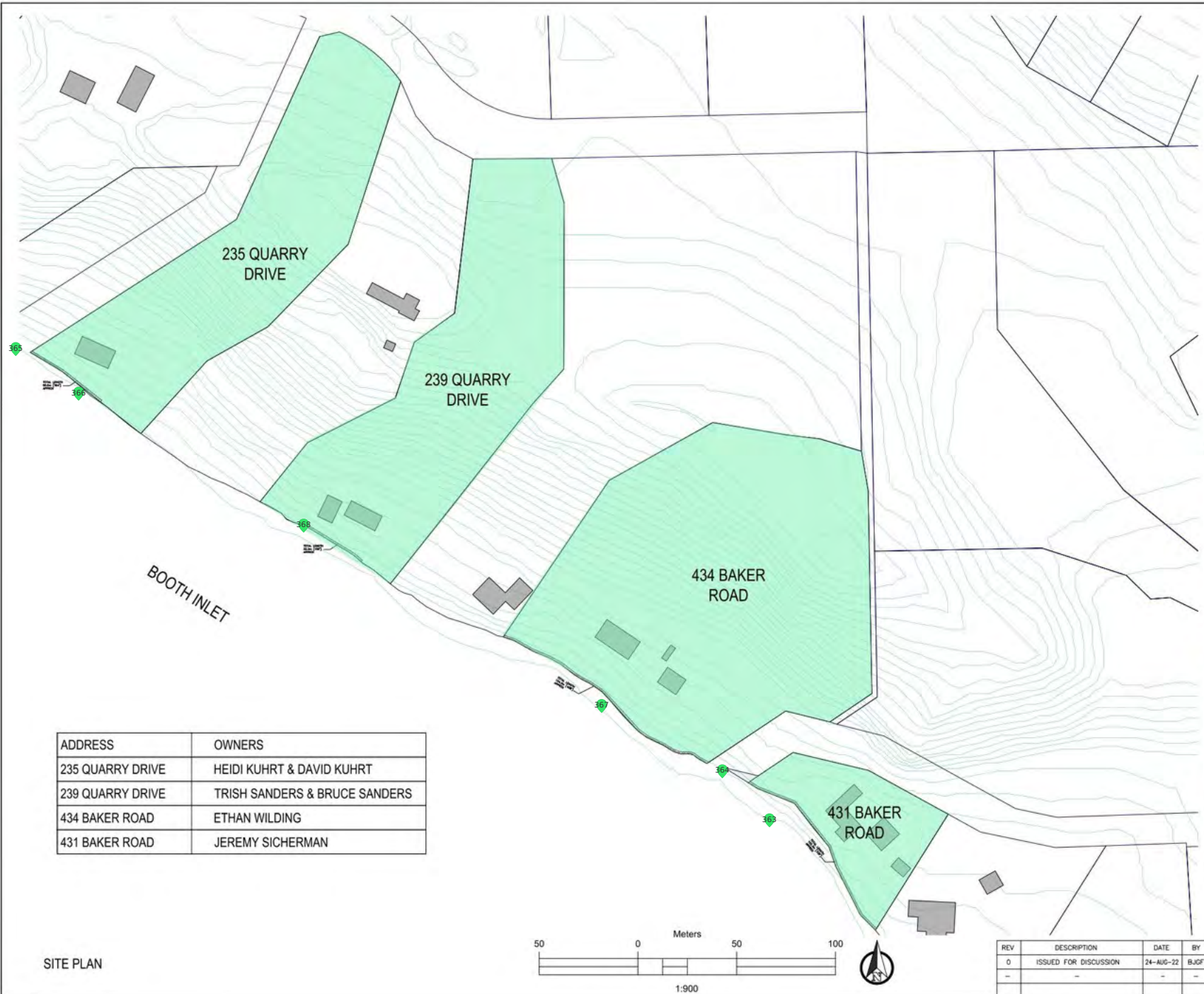

ADDRESS	OWNERS
235 QUARRY DRIVE	HEIDI KUHRT & DAVID KUHRT
239 QUARRY DRIVE	TRISH SANDERS & BRUCE SANDERS
434 BAKER ROAD	ETHAN WILDING
431 BAKER ROAD	JEREMY SICHERMAN

SITE PLAN

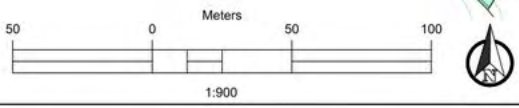

REV	DESCRIPTION	DATE	BY
0	ISSUED FOR DISCUSSION	24-AUG-22	BUJF
-	-	-	-

GENERAL NOTES:
 1) DIMENSIONS IN METRES UNLESS STATED OTHERWISE.
 2) NOT TO BE USED FOR CONSTRUCTION. FOR PLANNING PURPOSES ONLY.

DESIGN NOTES:

LEGENDS:



SALT SPRING ISLAND BRITISH COLUMBIA, CANADA
 thinkpg.com / +1 250-930-2426
 EGBC PERMIT TO PRACTICE NO: 100204

PROJECT TITLE:
BEACH EROSION PROJECT
 2022.68 QUARRY DRIVE

CLIENT:
 QUARRY BEACH OWNERS GROUP

PROJECT LOCATION:
 SALT SPRING ISLAND, BC

DRAWING NO:
 2022.68-46-LAY-006

PERMIT NO: TBC DATE: 5-Oct-22

DESIGN BY: BUJF
 DRAWN BY: VBB
 SIZE: A1
 SCALE: 1:900
 REVIEWED BY: CC
 SHEET: 60F6

235 QUARRY DRIVE - FACING SOUTH (JUNE 2023)



WEST OF 235 QUARRY DRIVE - FACING NORTH -
CRD STAIRCASE AND ARMOURING (JUNE 2023)



WEST OF 235 QUARRY DRIVE - FACING NORTH -
CRD STAIRCASE AND ARMOURING (JUNE 2023)



235 QUARRY DRIVE - FACING NORTH (JUNE 2023)



An aerial photograph showing a property with a large, dark-roofed house situated on a wooded hillside. The house is surrounded by dense green trees. Below the house, a steep, rocky slope descends to a wide, grey, rocky beach. The beach is littered with numerous pieces of driftwood and scattered rocks. The overall scene is a mix of natural elements and human habitation.

235 QUARRY DRIVE - FACING NORTH (JUNE 2023)

239 QUARRY DRIVE - FACING NORTH (JUNE 2023)



239 QUARRY DRIVE - TREE TOPPLE (22-FEB-2024)



239 QUARRY DRIVE - TREE TOPPLE (22-FEB-2024)



239 QUARRY DRIVE - TREE TOPPLE (22-FEB-2024)







239 QUARRY DRIVE - TREE TOPPLE (22-FEB-2024)





Summary of Areas Recommended to Mitigation

Pot Size	Treatment Recommendation	Planting Area
• 1 gallon	 Upland riparian revegetation	 Concept Planting
• 2 gallon	 Re-vegetation and bioengineering	 Beach nourishment application areas
• 3 gallon	 Recommended wave deflection	

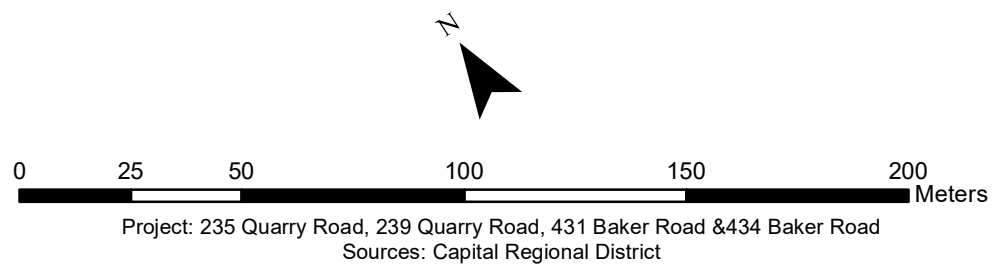

Corvidae Project No.
COR-2023-050

Rev. #	Date
0	January 26, 2024

Figure 1